

## PREMIUM CYLINDER REGULATOR SERIES

# GCE ProStage®

### FEATURES

- Two-stage regulation for **constant** and **precise** outlet pressure and flow
- High-performance regulator following specific needs of technical gas applications
- **Robust** rubber gauge protection preventing damages and impurities
- **Prolonged lifetime** saving costs related to services and spares
- **Safety pressure relief valve** opens at a specific pressure to stop possible getting of high pressure to the outlet point
- **Easy handling** for the operator by **ergonomic** arrangement
- Three scale pressure gauges acc. to ISO 5171 with high contrast pointer for **better** gas pressure **clarity**
- Encapsulated regulating technology for precise parameters **stability**
- **Safety** focused design following ISO 2503
- Up to **300 bar** cylinder pressure



### DIMENSIONS SCHEME

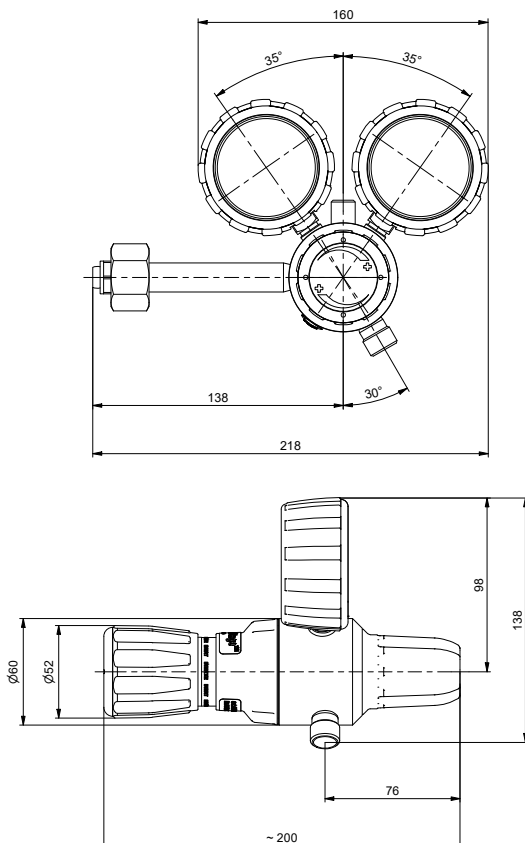

### TECHNICAL DATA

Gas	O <sub>2</sub> , N <sub>2</sub> , H <sub>2</sub> , Ar, Air, CO <sub>2</sub>
Body	Brass forged
Bonnet	Zn/Al alloy Die Cast
Stems, nuts and fittings	Brass
Diaphragm	EPDM
Seat sealing	PA
Inlet/ Outlet connection	Gas specific connection
Maximal inlet pressure	80, 200, 300 bar
Outlet pressure	0-1,5 bar
	0-4bar
	0-10 bar
	0-20 bar
Temperature range	From -20°C to 60°C
Weight	Approx. according to gas variant: 2,4 kg
Pressure relief valve	Used in all variants