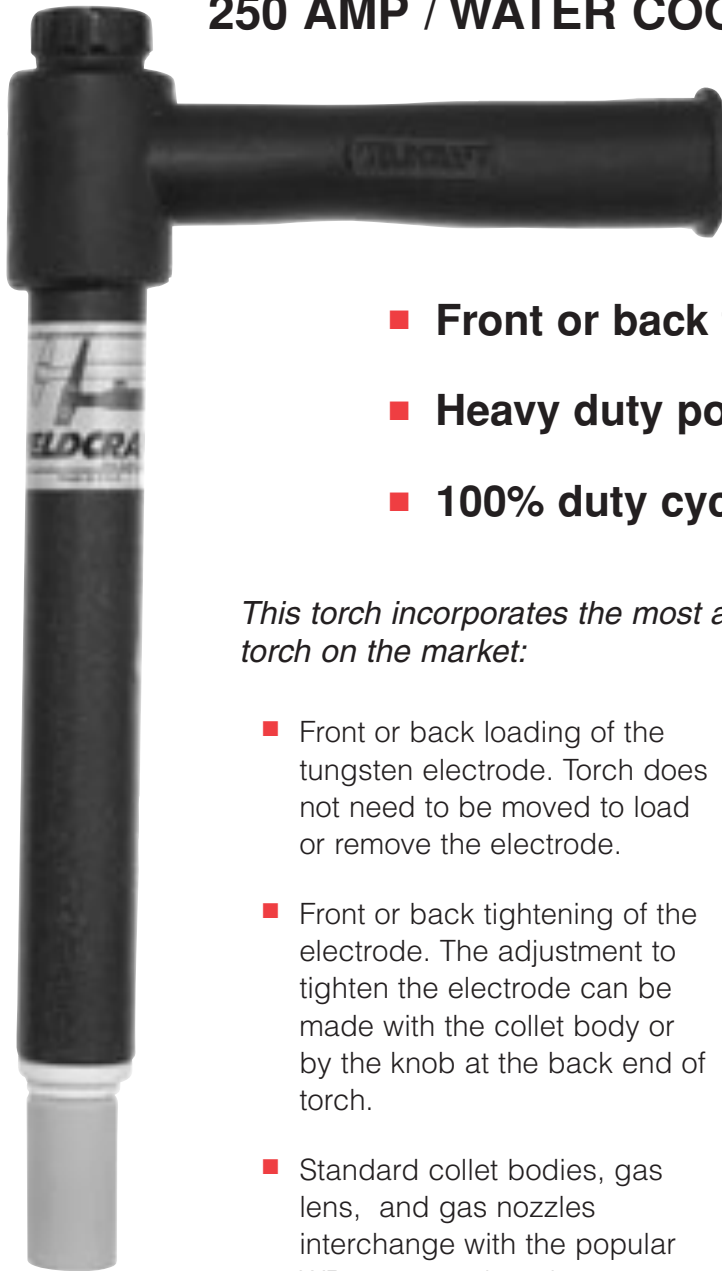

WP-22**250 AMP / WATER COOLED MACHINE TORCH**

- **Front or back tungsten loading**
- **Heavy duty power cable**
- **100% duty cycle rating**

This torch incorporates the most advanced features of any machine torch on the market:

- Front or back loading of the tungsten electrode. Torch does not need to be moved to load or remove the electrode.
 - Front or back tightening of the electrode. The adjustment to tighten the electrode can be made with the collet body or by the knob at the back end of torch.
 - Standard collet bodies, gas lens, and gas nozzles interchange with the popular WP-20 manual torch.
 - Also available in air-cooled - see WP-23A
 - Choice of models. Model A is 7-3/4 inches overall length and uses 7" long tungsten electrodes. Ideally suited for clamp type mounting fixture.
- Model B is 4-1/2 inches overall length and uses 3" long tungsten electrodes.
- Both models use a 3/4 inch diameter barrel.
- Both models are available with 3, 6, 12-1/2 and 25 foot hose and cable assemblies.

WP-22A-3 'A' model torch pkg., 3' (0.9M)

WP-22B-3 'B' model torch pkg., 3' (0.9M)

WP-22A-6 'A' model torch pkg., 6' (1.8M)

WP-22B-6 'B' model torch pkg., 6' (1.8M)

WP-22A-12 'A' model torch pkg., 12-1/2' (3.8M)

WP-22B-12 'B' model torch pkg., 12-1/2' (3.8M)

WP-22A-25 'A' model torch pkg., 25' (7.6M)

WP-22B-25 'B' model torch pkg., 25' (7.6M)



Model WP-22 / Water Cooled Machine Torch / 250 AMPS



Features:

- Front or back tungsten loading
- Heavy duty power cable
- Continuous duty
- Also available in air cooled - see WP-23A

Specifications:

	22A	22B
Capacity (Max) (dcsp).....	250 amps	250 amps
Weight (less power cable)	5.6 OZ	3.5 OZ
Torch Length	6 1/2"	3 1/2"
Handle Diameter	3/4"	3/4"

Water cooled torches require cooling water flow of 1 quart (.94 liter) to 1-1/2 quarts (1.4 liters) per minute at a maximum of 50 PSI pressure.

Part No.	Description	Max Amps	Overall T/B Length
WP-22A WP-22A-3 WP-22A-6 WP-22A-12 WP-22A-25	Torch Body Torch Pkg., 3' (0.9M) Torch Pkg., 6' (1.8M) Torch Pkg., 12-1/2' (3.8M) Torch Pkg., 25' (7.6M)	250	7-3/4" (198mm)
WP-22B WP-22B-3 WP-22B-6 WP-22B-12 WP-22B-25	Torch Body Torch Pkg., 3' (0.9M) Torch Pkg., 6' (1.8M) Torch Pkg., 12-1/2' (3.8M) Torch Pkg., 25' (7.6M)	250	4-1/2" (114mm)

Model A uses 7" long tungsten electrodes

Model B uses 3" long tungsten electrodes

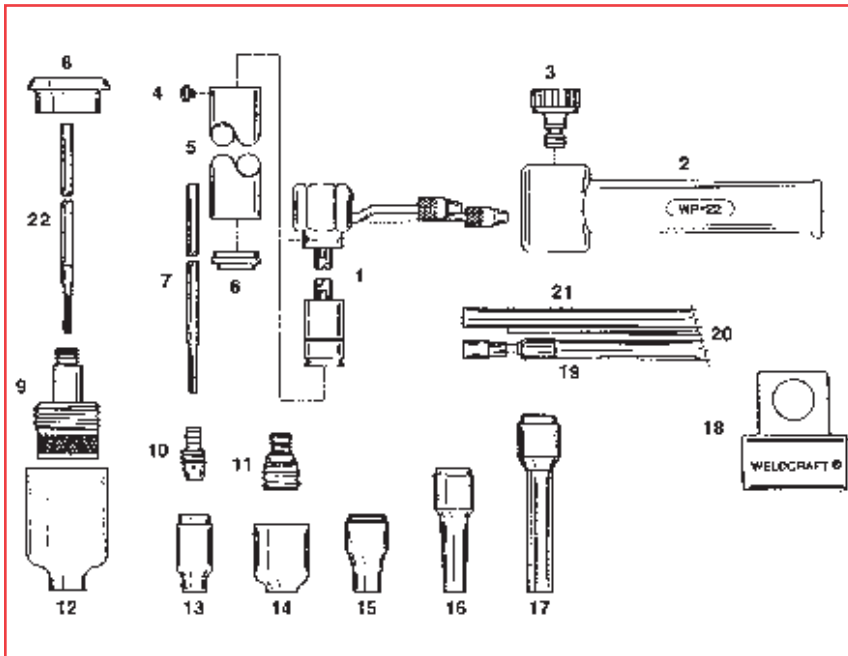

Chart A: Collets, Collet Bodies, Gas Lens

ITEM NO.	DESCRIPTION	ELECTRODE DIAMETER			
		.040	1/16	3/32	1/8
7	Collet	22N21A	22N22A	22N23A	22N24A
		22N21B	22N22B	22N23B	22N24B
10	Collet Body	13N26	13N27	13N28	13N29
11	Gas Lens	45V42	45V43	45V44	45V45
22	Lg. Dia. Gas Lens Collet**	22N21AL	22N22AL	22N23AL	22N24AL
9	Lg. Dia. Gas Lens**	45V0204S	45V116S	45V64S	995795S

** Available for WP-22A model only

Chart B: Gas Nozzles, HPN - High Performance Nozzles Available

ITEM NO.	DESCRIPTION	SIZE								
		3	4	5	6	7	8	10	12	SHORT
13	Alumina		13N08	13N09	13N10	13N11	13N12	13N13		
14	Alumina Gas Lens		53N58	53N59	53N60	53N61	53N61S			
12	Lg. Dia. Gas Lens				57N75		57N74	53N88	53N87	53N89*
15	Lava		13N14	13N15	13N16	13N17	13N18	13N19		
16	Long Lava	796F70	796F71	796F72	796F73					
17	Ex. Long Lava	796F74	796F75	796F76	796F77					

- * Not recommended for use with high frequency current
 • HPN nozzle available

Item No.	Part No.	Description
1	WP-22A WP-22B	7" long torch body 3" long torch body
2	22-9	Insulating boot
3	22-7	Collet knob, includes 98W77 O-ring
4	18R-1	6-32 x 3/16" fillister head screw
5	22-8A 22-8B	7" barrel 3" barrel
6	22-10	Cup gasket
7	—	Collet (See chart A)
8	54N63-22	Lg. diameter gas lens insulator
9	—	Lg. diameter gas lens (See chart A)
10	—	Collet body (See chart A)
11	—	Gas lens (See chart A)
12	—	Lg. diameter gas lens nozzle (See chart B)
13	—	Alumina nozzle (See chart B)
14	—	Alumina gas lens nozzle (See chart B)
15	—	Lava nozzle (See chart B)
16	—	Long lava nozzle (See chart B)
17	—	Extra long lava nozzle (See chart B)
18	45V11	Power cable adapter
19	—	Power Cable
	45V03HD-L3	3 ft. (0.9M)
	45V03HD-L6	6 ft. (1.8M)
	45V03HD	12-1/2 ft. (3.8M)
	45V04HD	25 ft. (7.6M)
	Gas Hose	
	45V09-L3	3 ft. (0.9M)
	45V09-L6	6 ft. (1.8M)
	45V09	12-1/2 ft. (3.8M)
	45V10	25 ft. (7.6M)
21	—	Water Hose
	45V07HD-L3	3 ft. (0.9M)
	45V07HD-L6	6 ft. (1.8M)
	45V07HD	12-1/2 ft. (3.8M)
	45V08HD	25 ft. (7.6M)
22	—	Lg. Dia. Gas Lens Collet (See chart A)

Accessories

Item	Description
Accessory Kit:	N/A
Cable Covers:	WC-3-10, WC-3-22
Hook-Up Kit:	HK-1 (Includes 45V11)
Extension Kit:	EK-1-25
QCS DIN Kit:	Q5W