

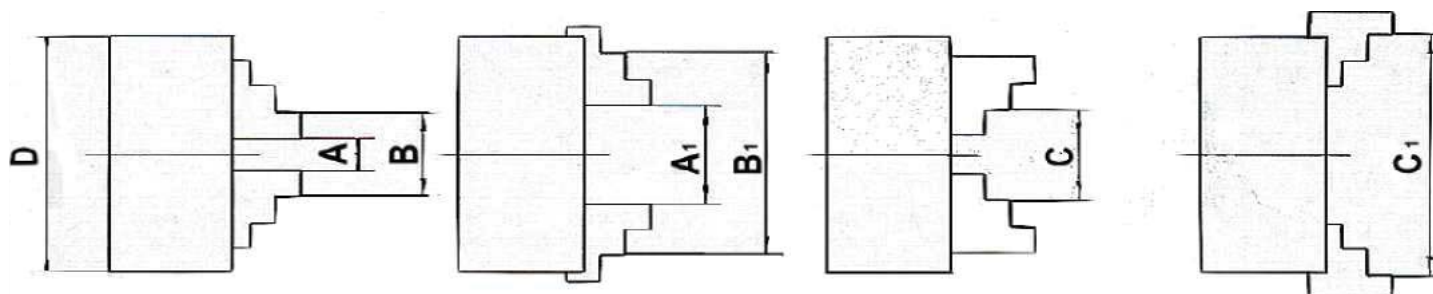

# T. BENTSEN AS

TELEFON +47 55 15 40 00 TELEFAX +47 55 15 40 10



### 3 Jaw Self-Centering Lathe Chuck- Plain Back

Order No.	MAX	A-A1	B-B1	C-C1
421-0080	70	2-22	25-70	22-63
421-0100	90	2-30	30-90	30-80
421-0125	125	2-40	38-125	38-110
421-0130	130	3-40	40-130	40-120
421-0161*	160	3-55	50-160	55-145
421-0201*	200	4-85	65-200	65-200
421-0241*	240	6-100	80-250	90-250
421-0251*	250	6-110	0-250	90-250
421-0316*	315	10-140	95-315	100-315
421-0321*	320	11,5-145	95-320	110-320
421-0326*	325	11,5-165	95-350	110-340
421-0381*	380	11,5-180	95-400	110-400
421-0400*	400	15-210	12-400	12-400
421-0500*	500	25-280	150-500	150-500
421-0630*	630	50-350	170-350	170-630



• High quality cast iron body.

• Hardened and ground drop-forged scroll plate of fine alloy steel.

• Fully hardened and ground jaws and pinion.

• With two set jaws.

1. set for inside clamping and

1. set for outside clamping

\* With two piece



# T. BENTSEN AS

TELEFON +47 55 15 40 00 TELEFAX +47 55 15 40 10



WTKA-100	Φ200-1080	Φ85-1080	6-M16×150	400	1500 Kg	
WTKA130	Φ200-1300	Φ85-1300	6-M16×150	500	1500 Kg	
WTKA-150	Φ200-1520	Φ85-1520	6-M16×150	500	2500 Kg	

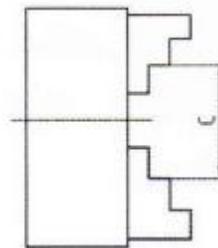
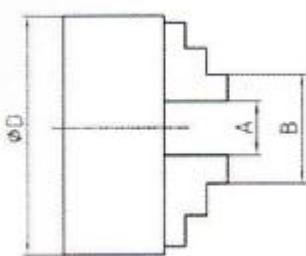

Spec	clamping rangeA-A1	clamping rangeB-B1	clamping rangeC-C1	P
K11-160	3-55	50-160	55-145	
K11-320	10-145	95-320	110-320	
K11-400	15-210	120-400	120-400	
K11-500C	25-280	150-500	150-500	
K11-630C	50-350	170-630	170-630	

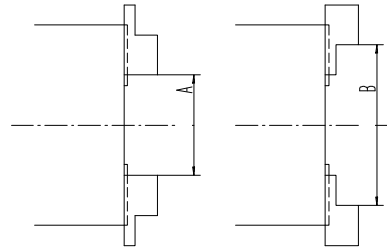
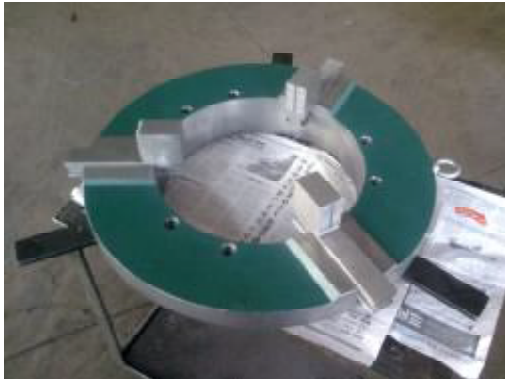

WP-200	Φ20-130	Φ110-210	3-M8×35	100	80	30 Kg	
WP-300	Φ80-190	Φ170-280	3-M8×30	120	100	120 Kg	
WP-400	Φ120-250	Φ250-380	3-M10×40	220	170	240 Kg	
WP-500	Φ200-340	Φ360-500	3-M12×55	240	240	600 Kg	
WP-600	Φ150-410	Φ400-620	6-M12×110	400	360	1000 Kg	
WP-750	Φ380-580	Φ550-800	6-M12×110	542.5	515	1200 Kg	



				Max. load	( )
WTKB-75	Φ170-750	4-M16×60	350	3000Kg	
WTKB-95	Φ170-950	4-M16×60	350	3000Kg	
WTKB-120	Φ170-1200	4-M16×60	460	3000Kg	