

PLASMA

TORCHES & CONSUMABLES



TORCHES
CONVERSION KITS
CONSUMABLES
REPLACEMENT PARTS

American Torch Tip *PHD*[®], *PHDX*[®] and Most Other Brands
Made In the USA

AMERICAN
TORCH TIP **ATTC**[®]

THERMAL DYNAMICS[®]

THERMAL DYNAMICS[®] PWH/M-3A

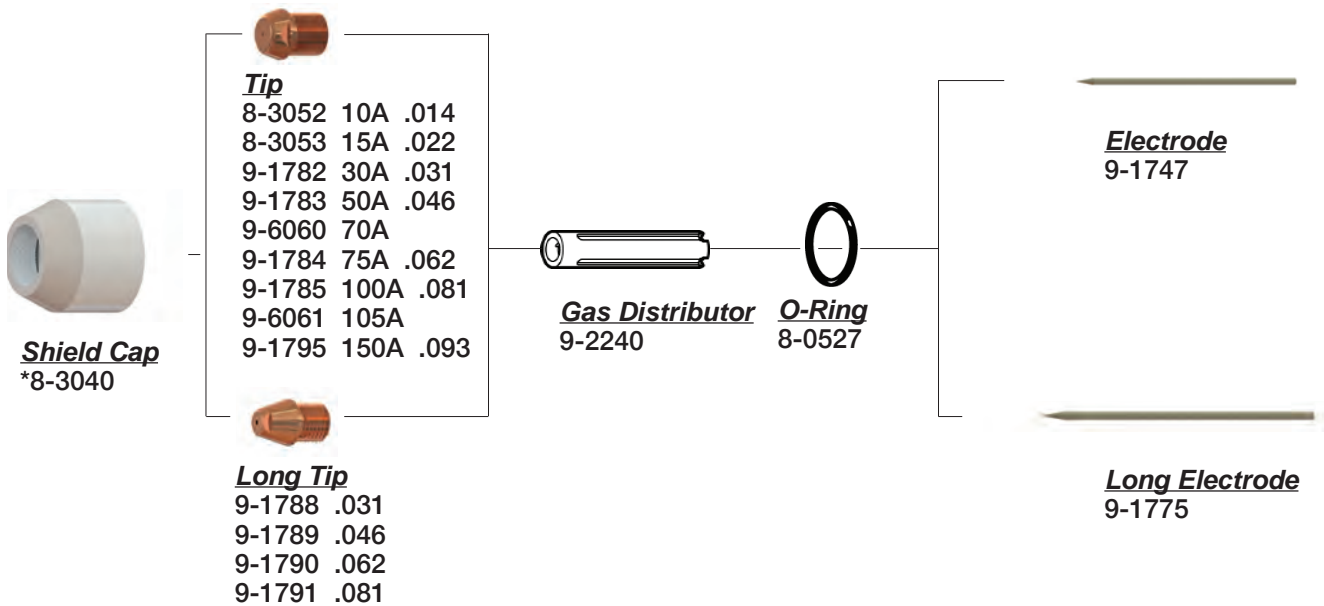

Not Shown

- *8-3030 70° Torch Body
- 9-1803 Long Black Cap
- 9-1779 Short Black Cap

THERMAL DYNAMICS®

THERMAL DYNAMICS® PWH-4A

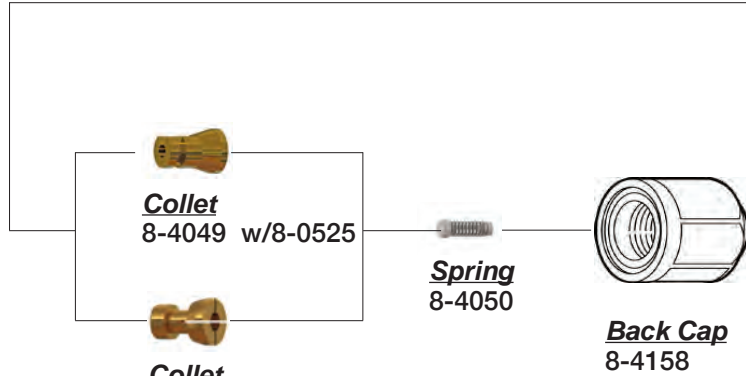
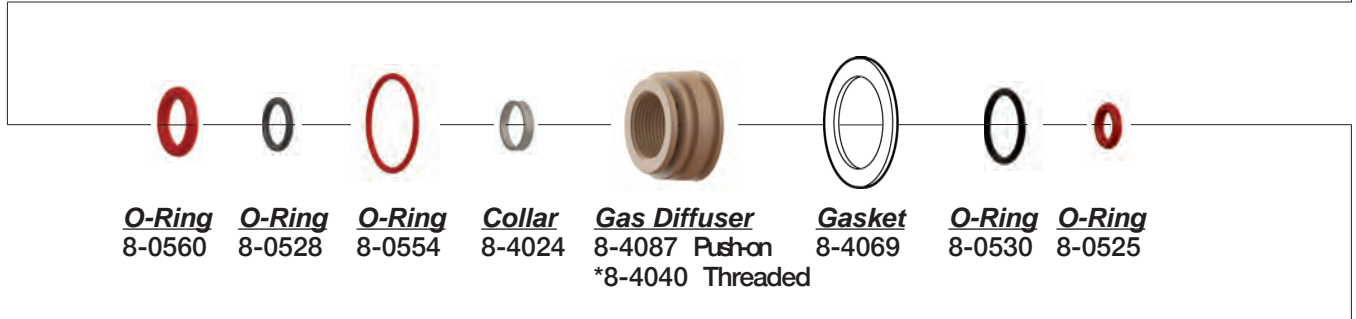
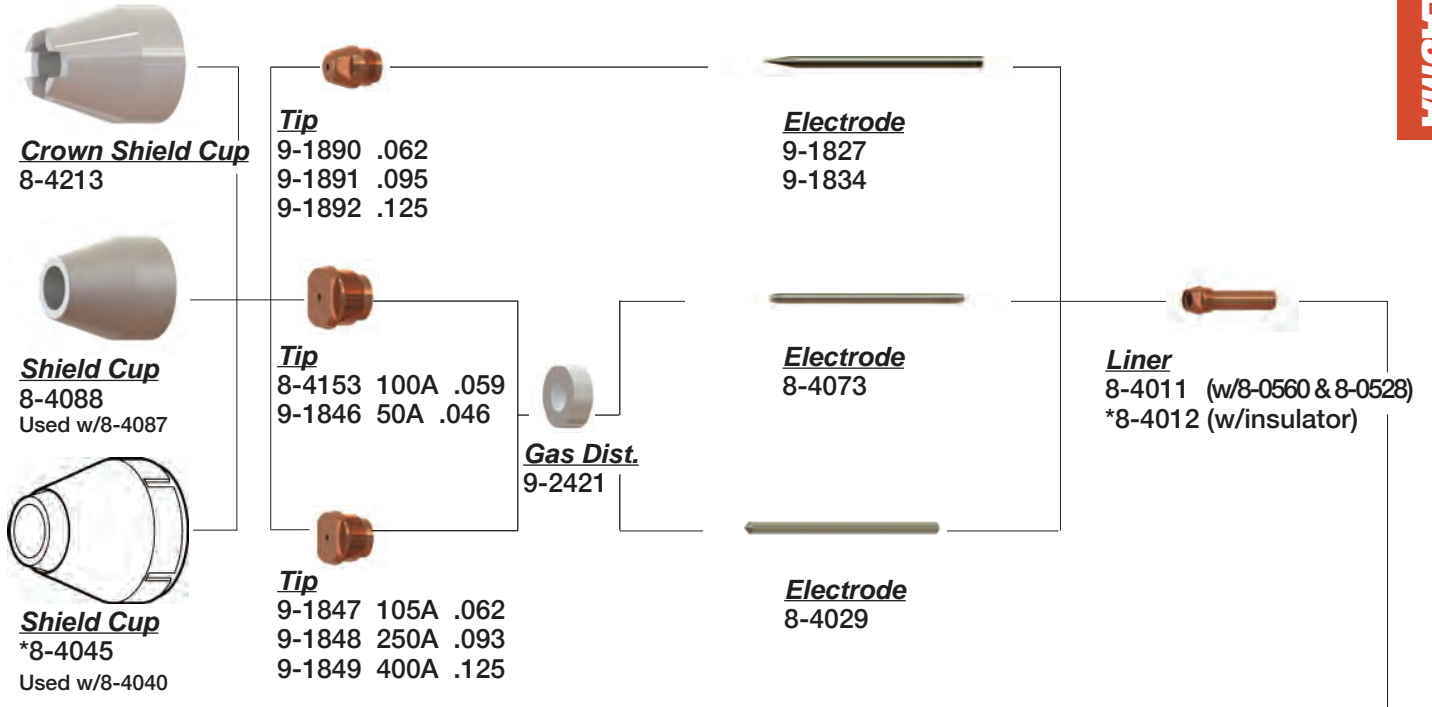

- Not Shown**
8-4091 Wrench
8-4053 Tip Wrench
9-2204 Insulator
8-4064 Shield Cup w/Screen

THERMAL DYNAMICS[®]

THERMAL DYNAMICS[®] PCH-4B & 4BT PAK[®] 10

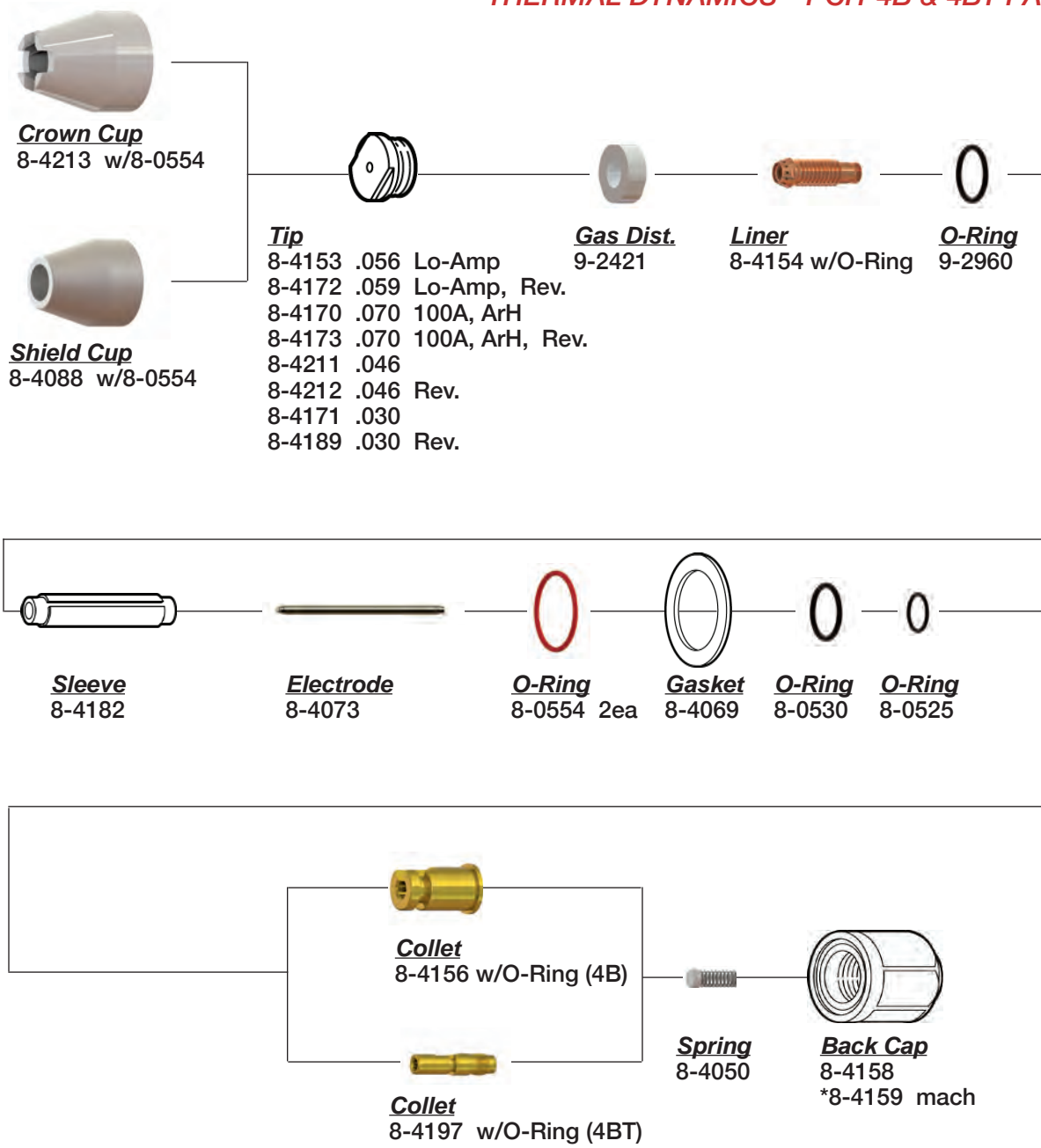

Not Shown

- 8-4157 Liner Wrench
- *8-4160 Torch Body 70°
- 8-4196 Torch Head 180°
- 8-4198 Collet Wrench
- 8-4007 Wrench

THERMAL DYNAMICS®

THERMAL DYNAMICS® PCH-6A

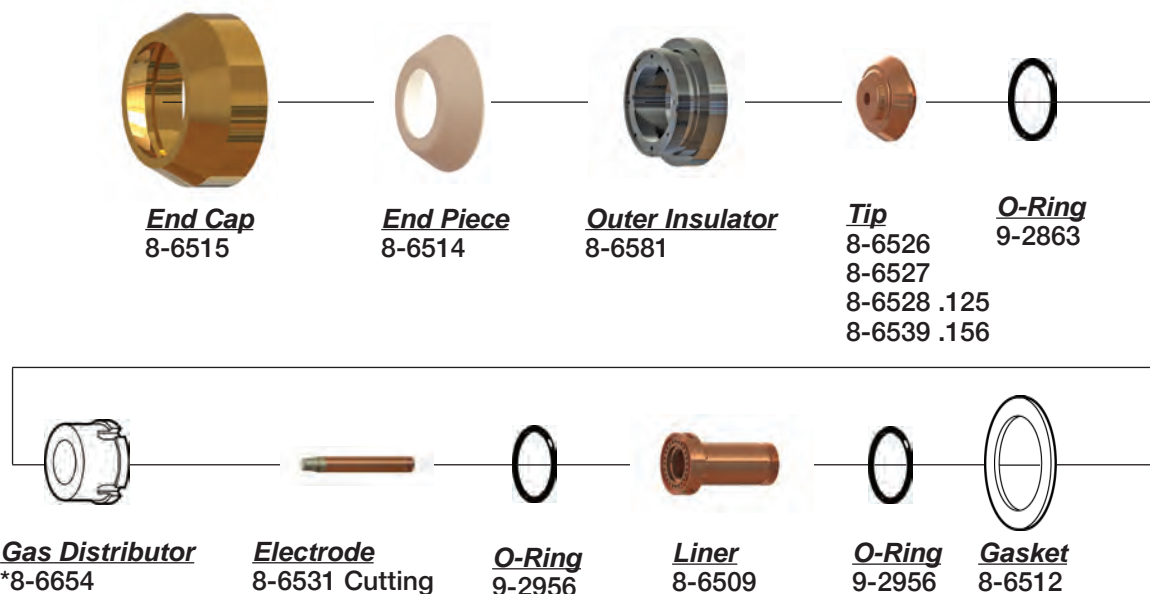

Not Shown

- *8-5031 Spring
- *8-6500 Torch Head Assy. 70°
- *8-6510 Collet Assembly
- *8-6523 Back Cap
- *8-6533 Sleeve

THERMAL DYNAMICS® PWM-6A

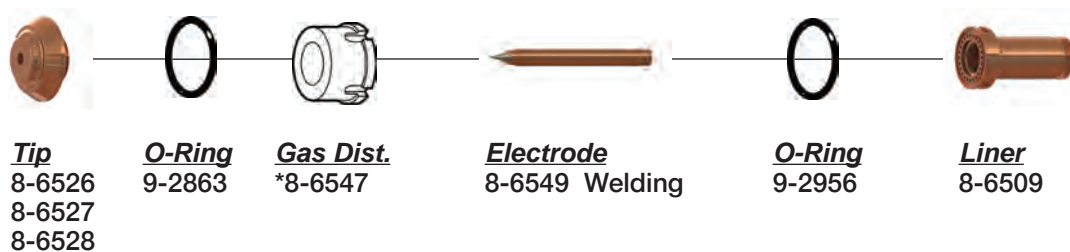

Not Shown

- 8-0534 O-Ring
- *8-5031 Spring
- *8-6502 Torch Head Assy.
- 8-6512 Gasket
- *8-6520 Back Cap
- *8-6542 Shield Cup
- *8-6541 Shield Adapter
- *8-6548 Collet Assembly
- *8-6565 Sleeve

THERMAL DYNAMICS[®]

THERMAL DYNAMICS[®] PCH-6B PAK[®] 44 & 45

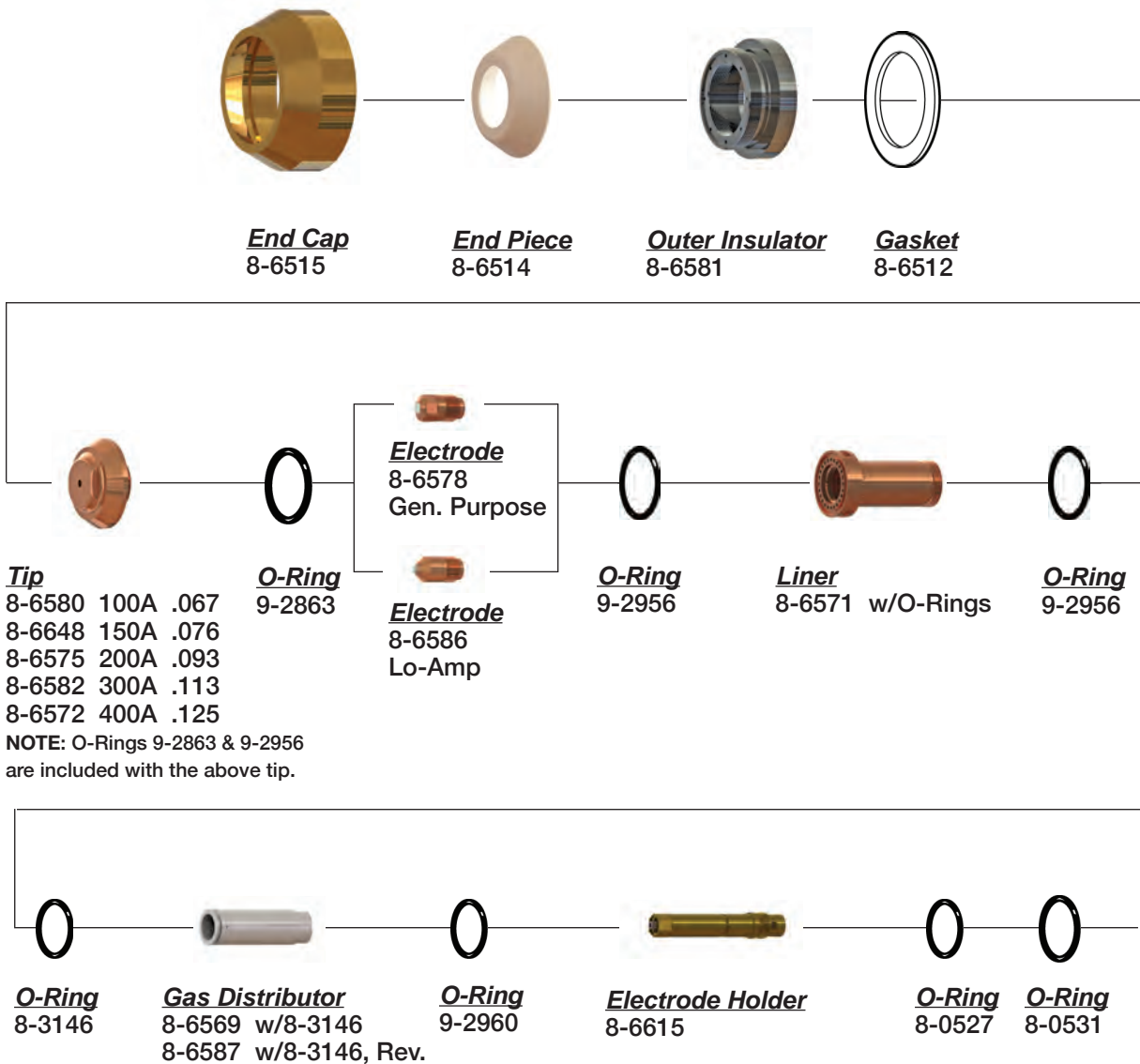

NOTE: O-Rings 9-2863 & 9-2956 are included with the above tip.

- Not Shown**
 *8-6517 Liner/Tip Wrench
 8-6573 Wrench
 8-6574 Wrench
 *8-6577 Torch Body
 8-8564 Torch

THERMAL DYNAMICS®

THERMAL DYNAMICS® PCH-20 DYNAPAK® 110

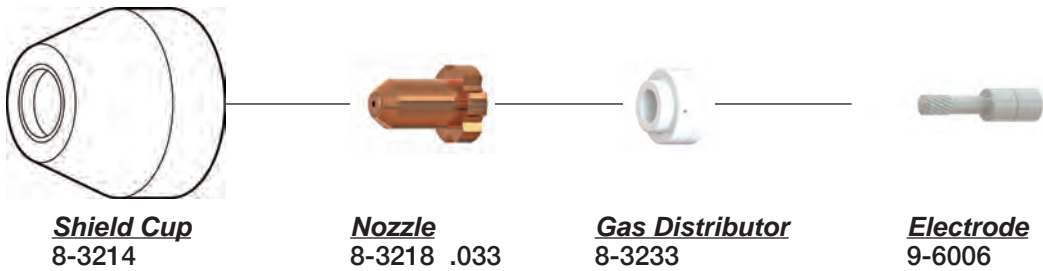

Not Shown
8-3220 Torch Head, 70°

THERMAL DYNAMICS® PCH-30 PAK® 3

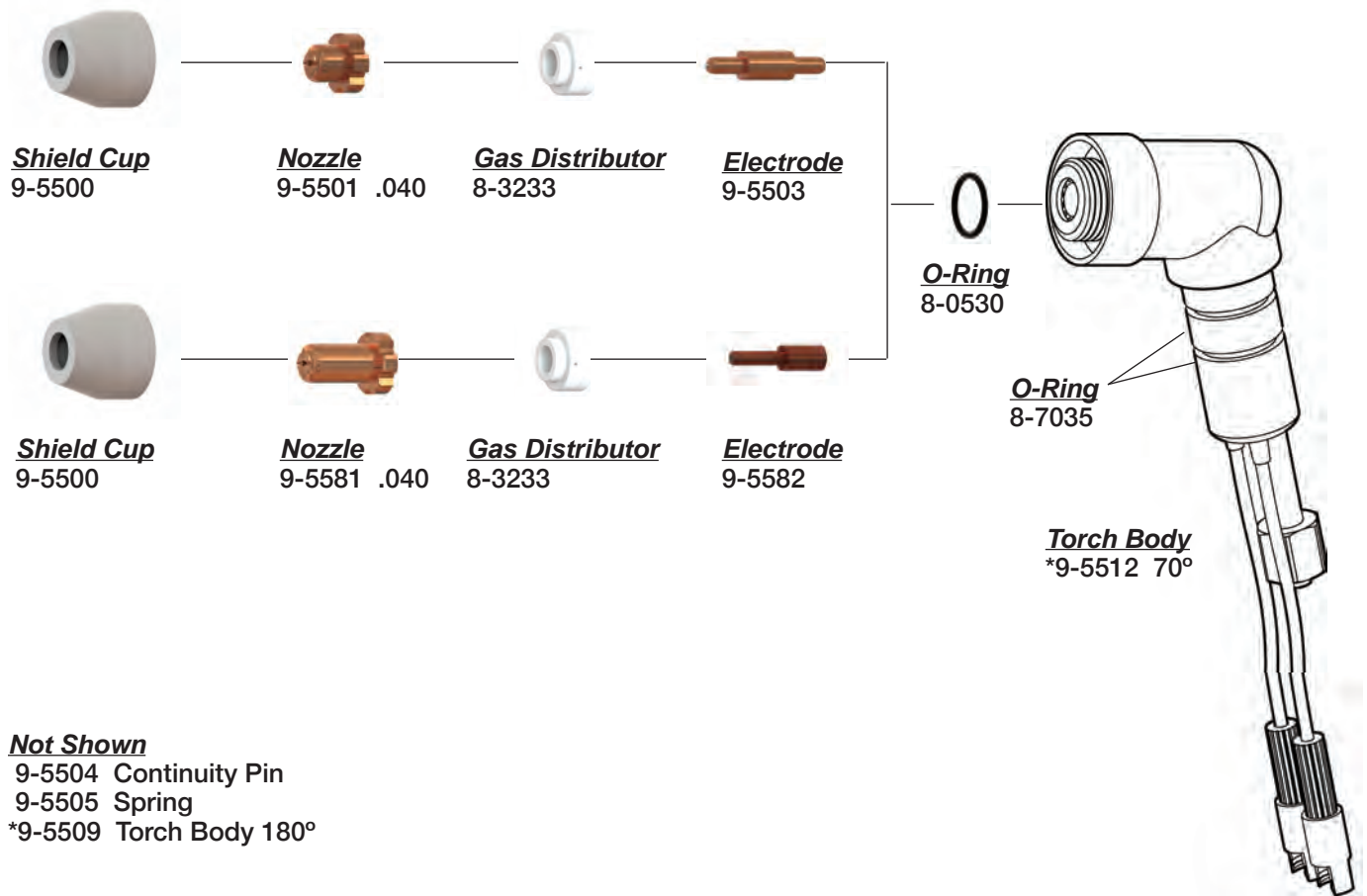

Not Shown
9-5504 Continuity Pin
9-5505 Spring
*9-5509 Torch Body 180°

THERMAL DYNAMICS[®]

THERMAL DYNAMICS[®] PCH/M-35

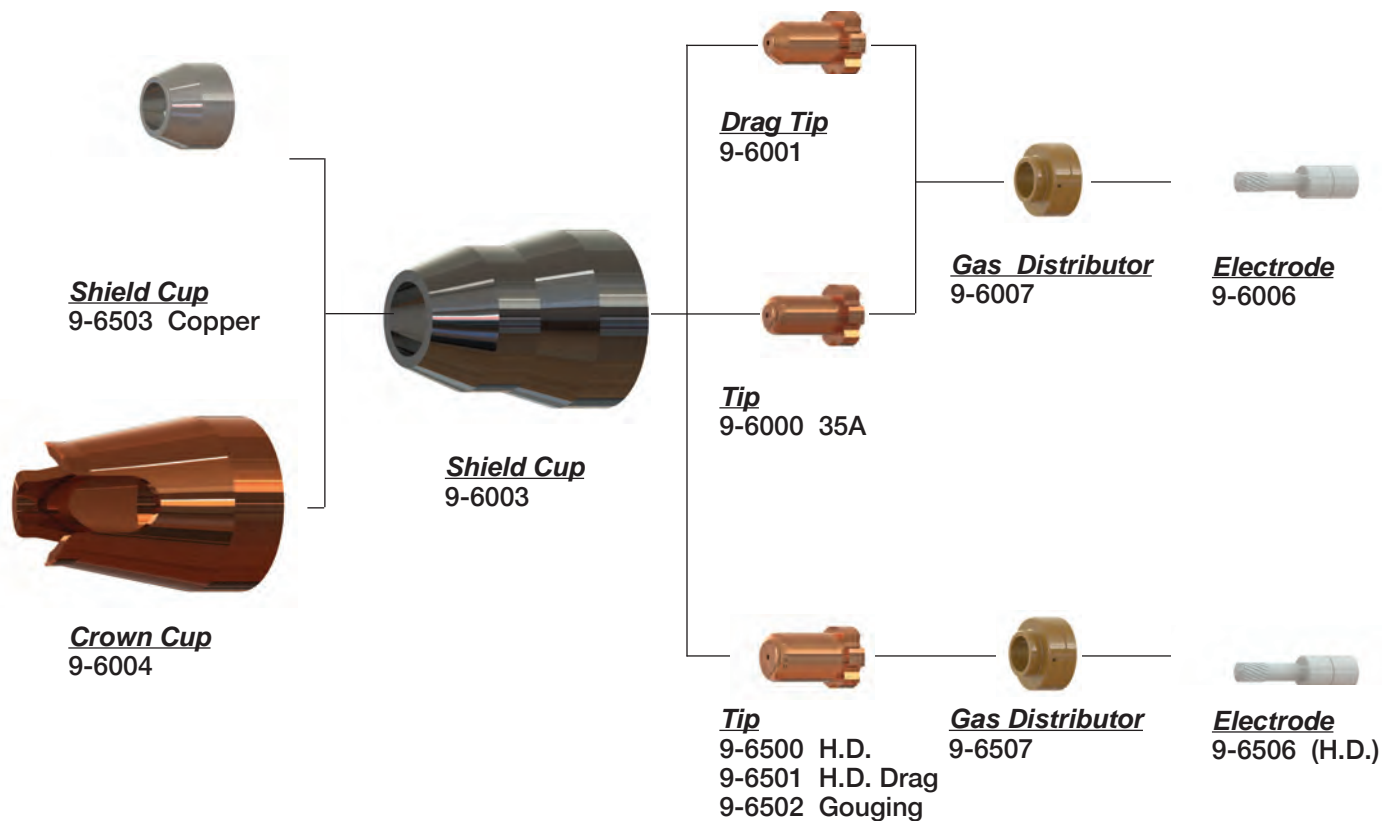

Not Shown

- *9-5807 Torch Body 70°
- *9-5809 Torch Body 180°

THERMAL DYNAMICS®

THERMAL DYNAMICS® PCH/M-40

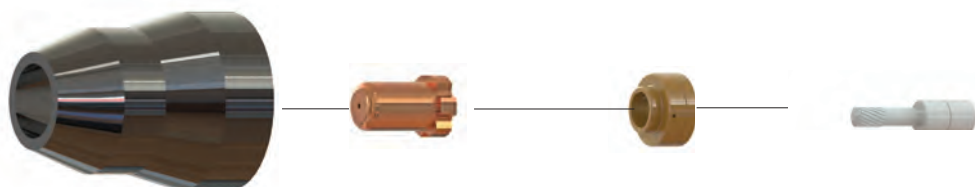

Shield Cup
9-6003

Tip
9-6500 H.D.
9-6501 H.D. Drag
9-6002 Gouging

Gas Distributor
9-6507

Electrode
9-6506 (H.D.)

Not Shown

- 9-6004 Crown Cup
- *9-8055 Torch Head 70°
- *9-8053 Torch Head 180°

THERMAL DYNAMICS® PCH-50 PAK® 5

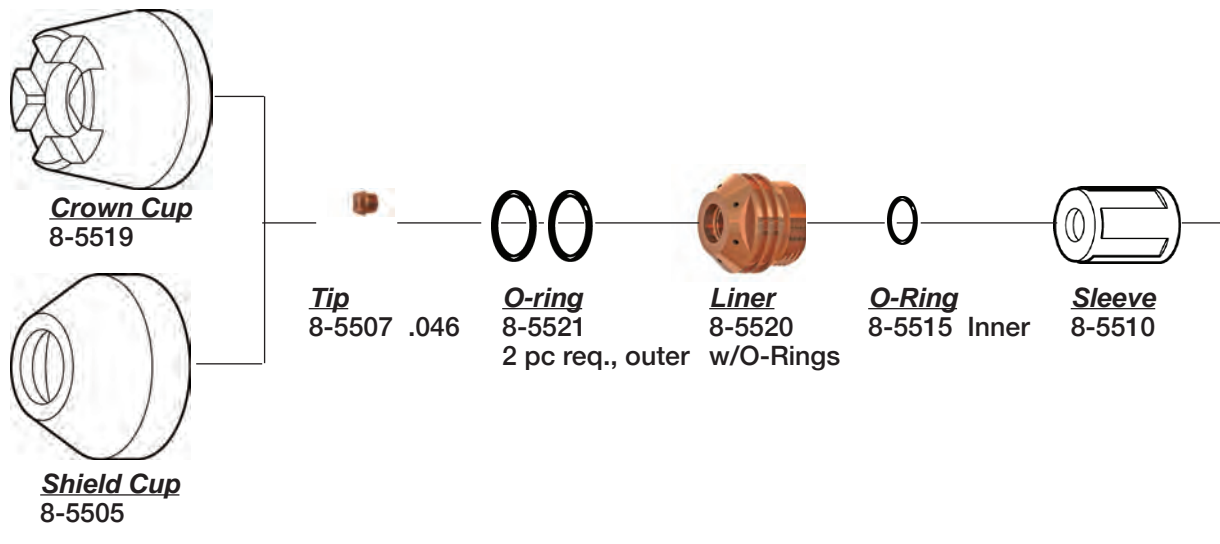

Crown Cup
8-5519

Shield Cup
8-5505

Tip
8-5507 .046

O-ring
8-5521
2 pc req., outer

Liner
8-5520
w/O-Rings

O-Ring
8-5515 Inner

Sleeve
8-5510

Electrode
8-5508

Collet
8-5506

O-Ring
8-5504

Spring
8-5503

Collet Release Button
8-5502

O-Ring
8-5514

Not Shown

- 8-5512 Wrench
- *8-5501 Torch Body 70°

THERMAL DYNAMICS[®]

THERMAL DYNAMICS[®] PCH-51 3XR[™], 4XI[™], 5XR[™]

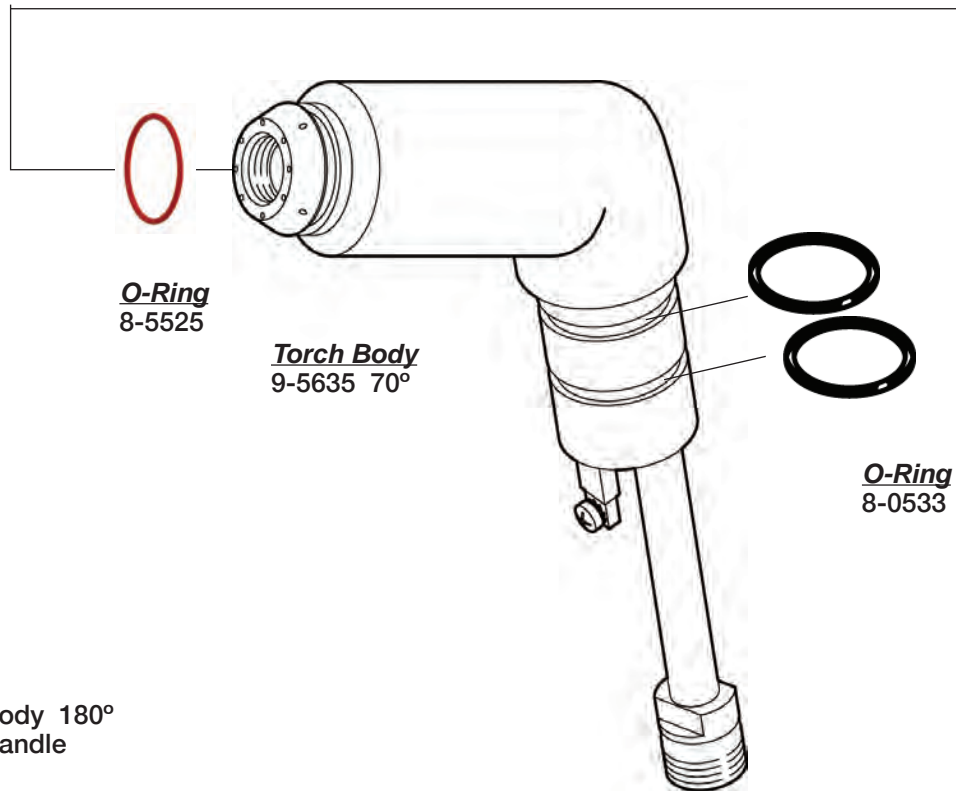
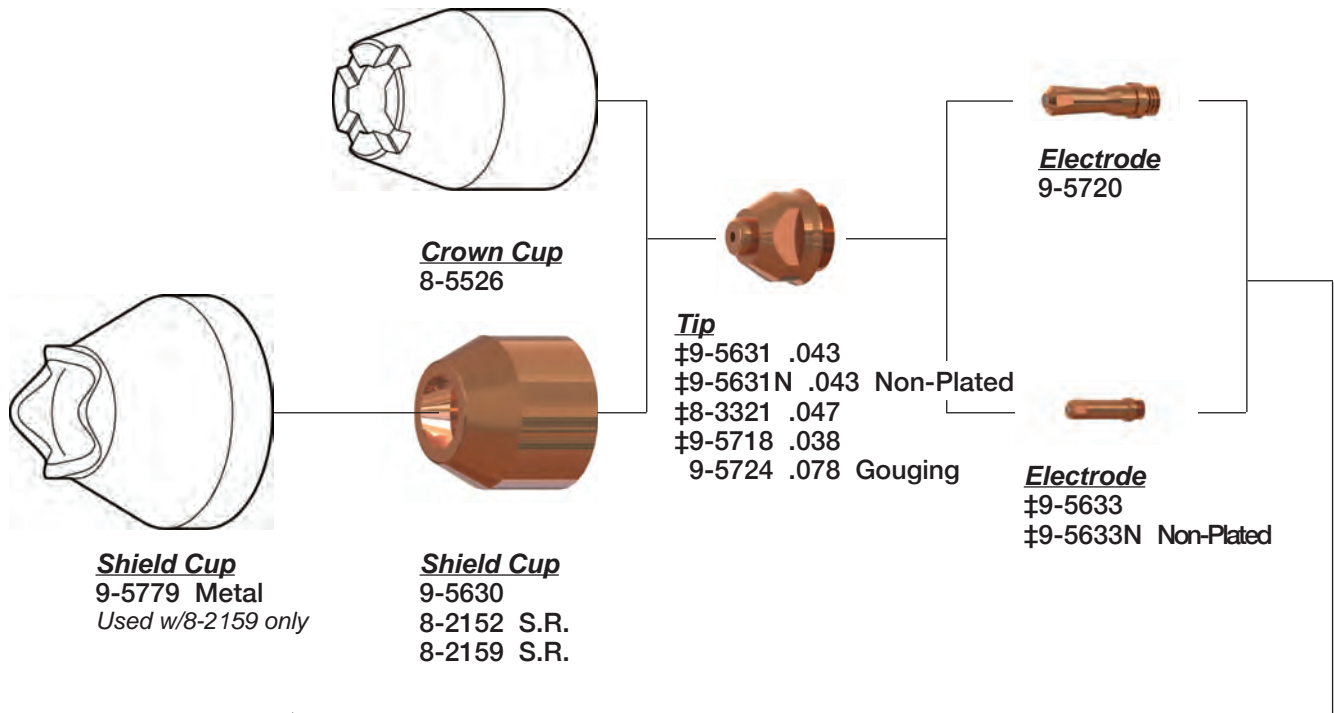

Not Shown
9-5522 Switch
9-5634 Torch Body 180°
9-5636 Torch Handle

THERMAL DYNAMICS®

THERMAL DYNAMICS® PCH-52, PCH-53 PAK5XR™, DG & 10XR™

PLASMA

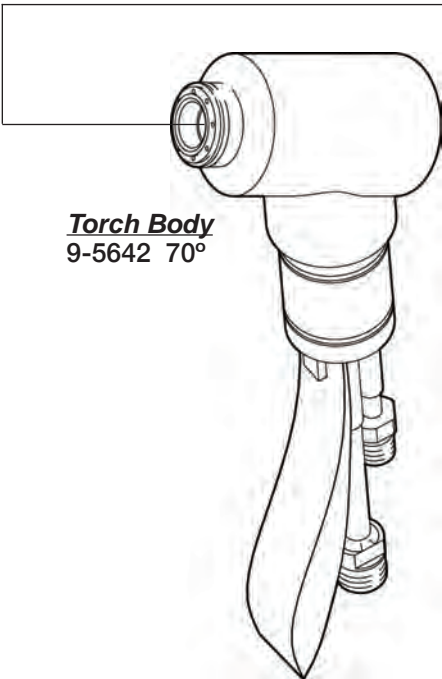
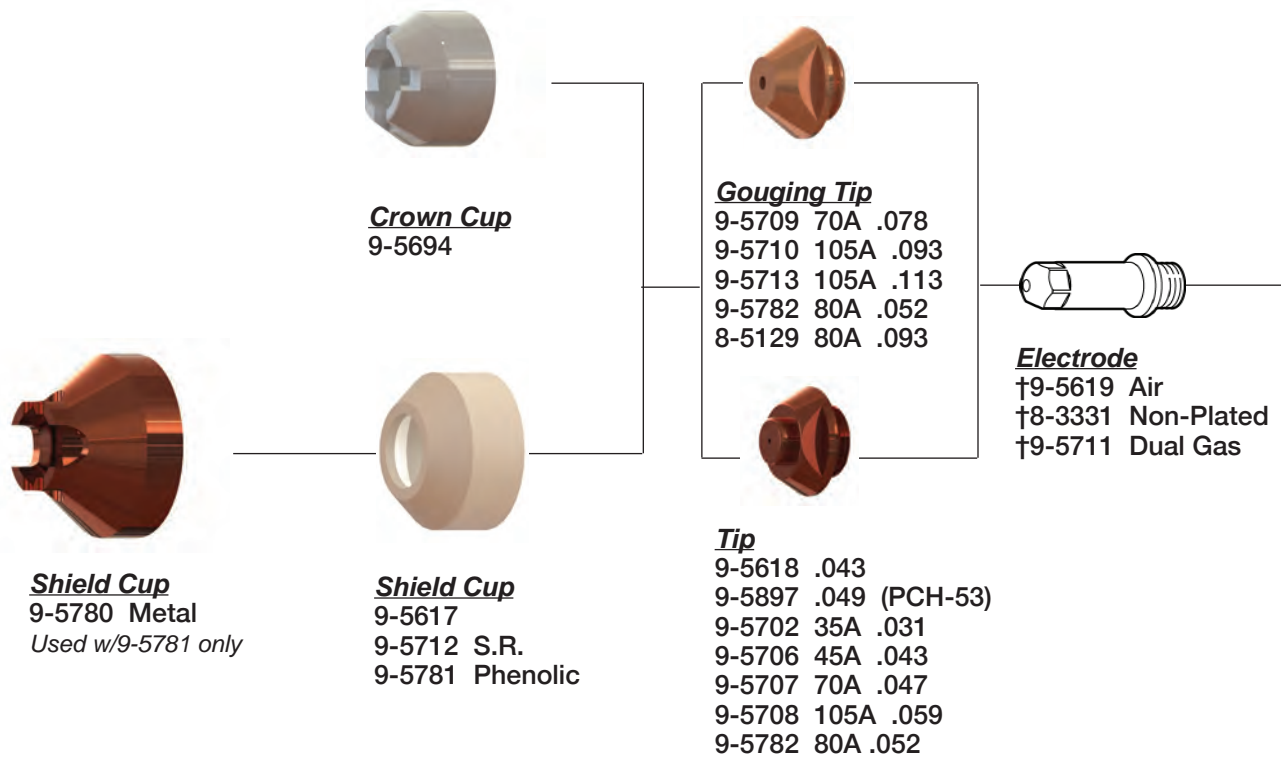

Not Shown

- 2-2936 Torch Assy. 70° w/25' Lead
- 2-2938 Torch Body w/25' Leads
- 8-5525 O-Ring
- 8-5128 Shield Cup, Gouging
- 8-5130 Heat Shield
- 9-5643 Torch Body 180°
- 9-5644 Handle
- 9-6170 Torch 70° PCH-53
- 9-6180 Torch 180° PCM-53

THERMAL DYNAMICS[®]

THERMAL DYNAMICS[®] PCH/M-60

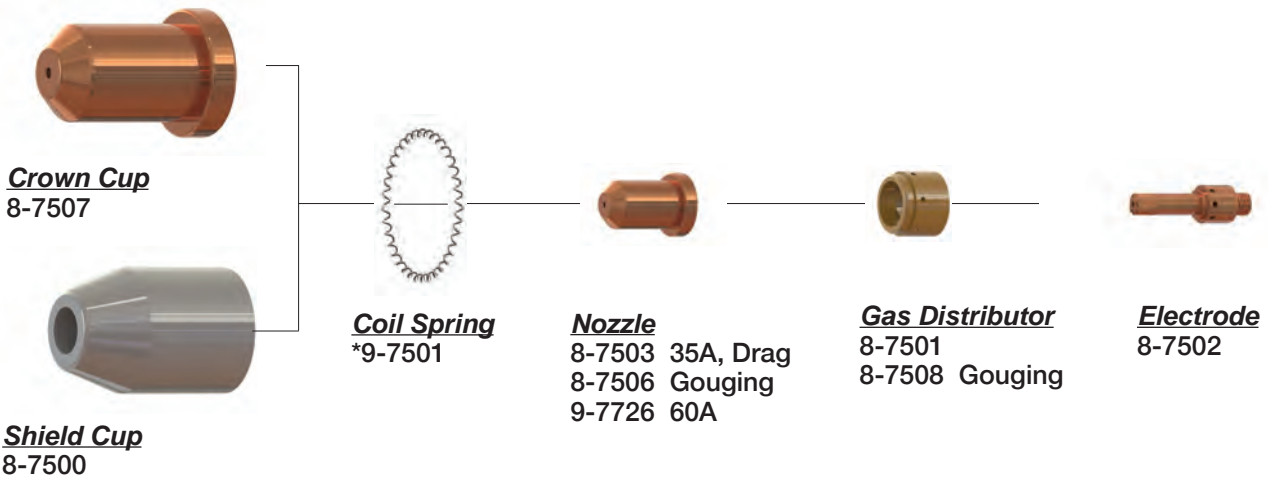

Not Shown

- *8-7525 Hi. Vis Shield
- *9-8073 Torch Head 180°
- *9-8075 Torch Head 70°

THERMAL DYNAMICS[®] PCH/M-70

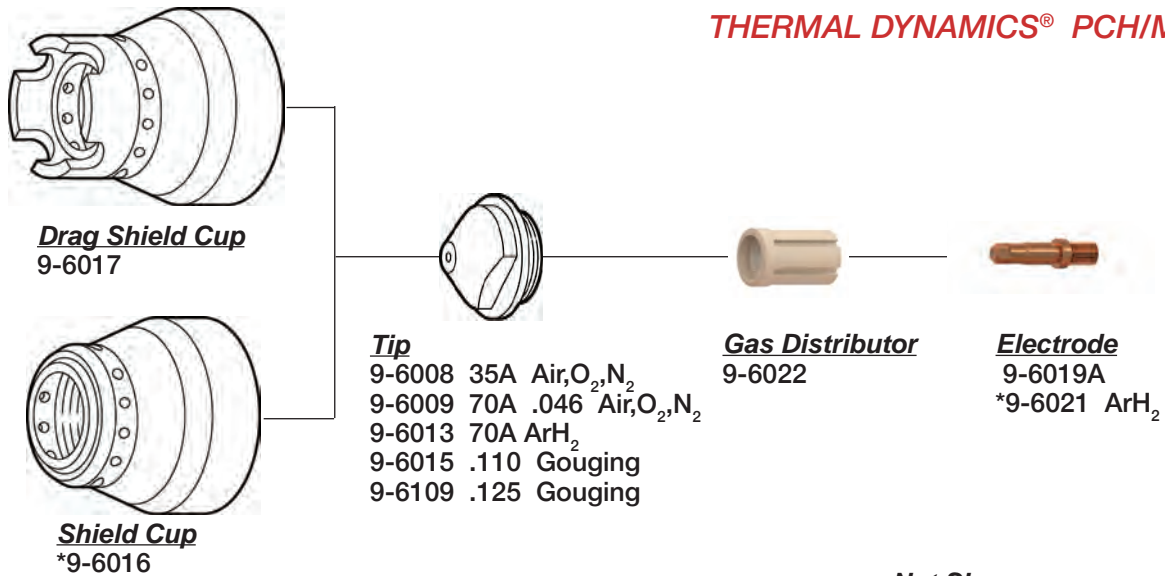

Not Shown

- *9-5810 Torch Head, 70°
- *9-5812 Torch Head, 180°
- *9-6018 Shield Cup

THERMAL DYNAMICS®

THERMAL DYNAMICS® PCH/M-75/100XL

PLASMA



Crown Cup
8-7507



Shield Cup
8-7500

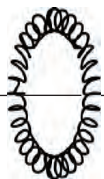

Coil Spring
*9-7501

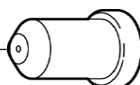

Nozzle
8-7503 35A, Drag
8-7504 55A, Air, N₂
8-7505 70A, Air, N₂ -100XL
8-7506 Gouging



Gas Distributor
8-7501
8-7508 Gouging



Electrode
8-7502 Air, N₂

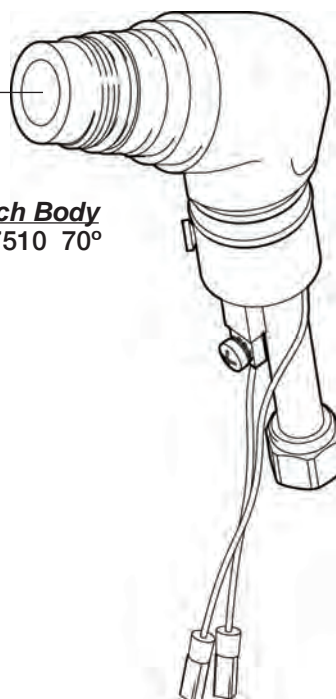

Torch Body
*8-7510 70°

Not Shown

- 2-0001 Torch 70° W/25' Lead
- *8-7511 Torch Body 90°
- *8-7512 Torch Body 180°
- *8-7525 Hi. Vis Shield

THERMAL DYNAMICS[®]

THERMAL DYNAMICS[®] PCH/M-80

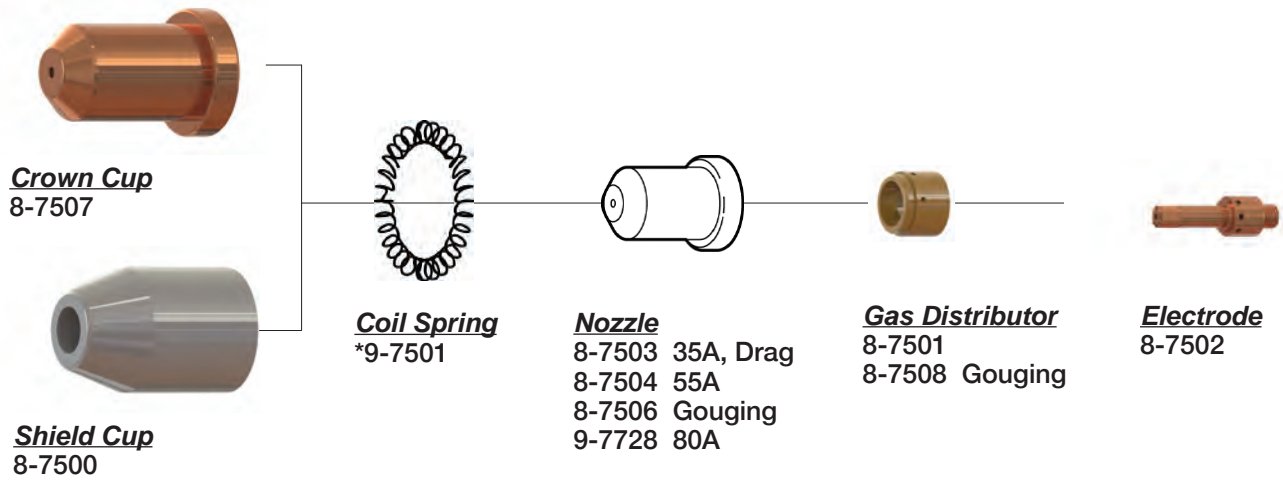

Not Shown

- 2-0080 Torch 70° W/25' Lead
- *8-7525 Hi. Vis. Shield
- *9-8073 Torch Head 180°
- *9-8075 Torch Head 70°

THERMAL DYNAMICS®

THERMAL DYNAMICS® PCH-100 PAK™ 10XR

PLASMA



Crown Cup
8-1101

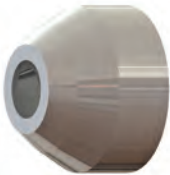

Shield Cup
8-1100

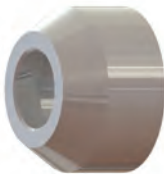

Shield Cup
9-4345 mach.

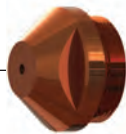

Tip
9-4341 105A .059
9-4342 70A .047
9-4343 35A .039



Electrode
9-4340

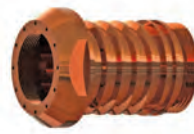

Liner
8-1106 (w/8-1135)

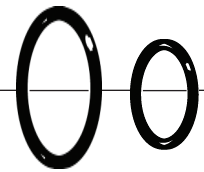

O-Ring **O-Ring**
8-1135 8-1134



Gas Distributor
9-4339 (w/8-1134)



O-Ring
8-1133



Electrode Holder
8-1108 (w/8-1133 & 8-1152)



O-Ring
8-1152

Not Shown

- 8-1109 Wrench
- 8-1110 Wrench
- 8-1111 Wrench
- *8-1112 Torch Head, 180°
- *8-1113 Torch Head, 70°

THERMAL DYNAMICS[®]

THERMAL DYNAMICS[®] PCH/M-102 SURELOK[™] RPT

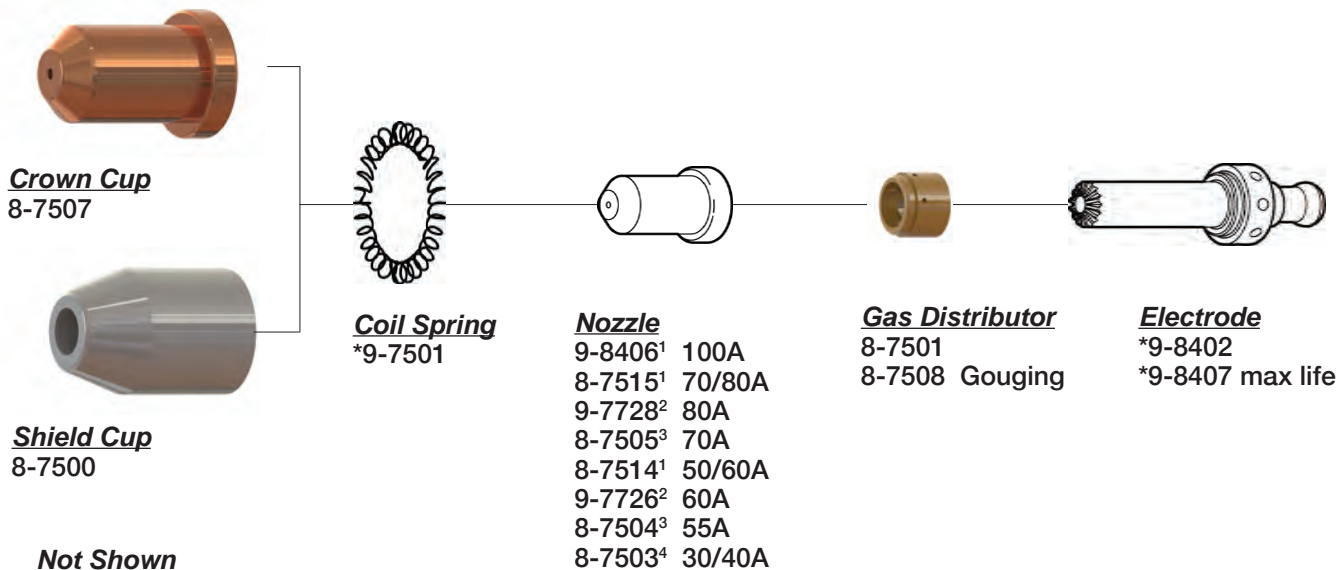

1) Used in torches for TDC XL Plus systems.
2) Used in torches for TDC XR's and other Manufacturer's systems.
3) Used in torches for TDC XL systems.
4) Used in torches for all systems.

THERMAL DYNAMICS[®] PCH/M-140

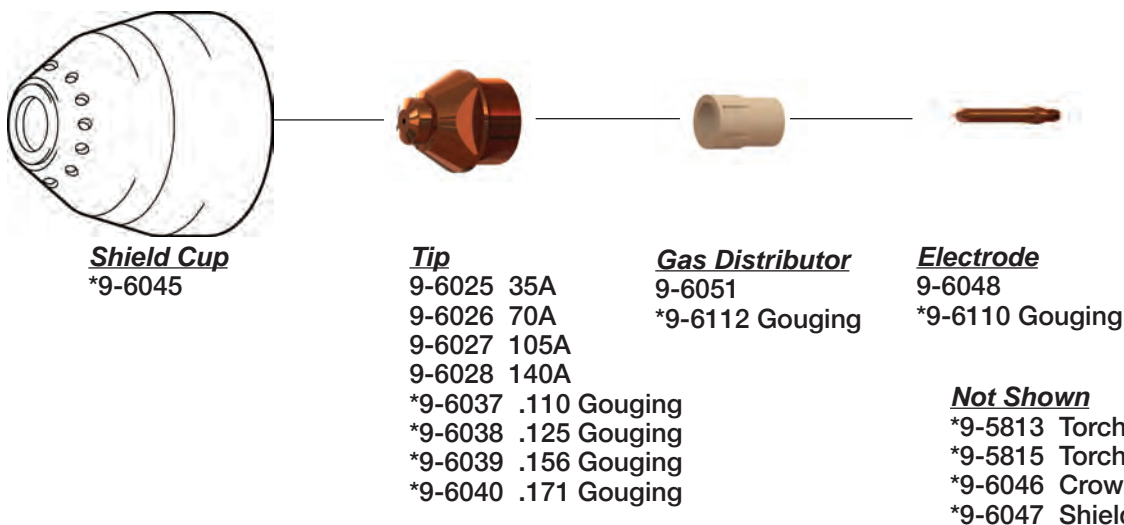

THERMAL DYNAMICS®

THERMAL DYNAMICS® PCH/M-145

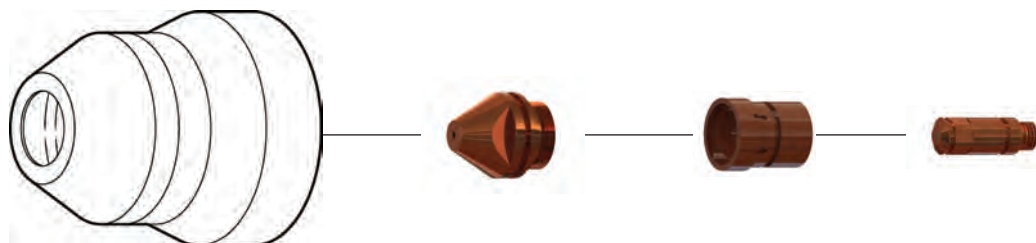

Shield Cup
*9-6075

- Tip**
 9-6055 35A
 9-6056 70A
 9-6057 105A
 9-6058 140A
 *9-6067 .110 Gouging
 *9-6068 .125 Gouging
 *9-6069 .156 Gouging
 *9-6070 .171 Gouging

Gas Distributor
9-6081

- Electrode**
 9-6078A Air
 *9-6129 N₂
 *9-6130 Gouging

Not Shown

- *9-5816 Torch Body 70°
 *9-6076 Crown Cup
 *9-6077 Gouging Shield Cup
 *9-6410 Torch Body 180°

THERMAL DYNAMICS® PCH/M-150 MERLIN 15XC

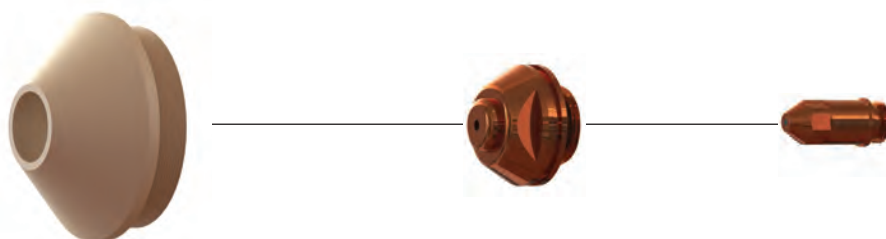

- Shield Cup**
 9-5750 Ceramic Frt.-Std.
 9-5758 Tip Ext.
 9-5774 Gouging
 9-5790 Metal Frt.-Std.
 9-5801 Copper
 9-5774T
 9-5758T
 9-5750T
 9-5790CT
 9-5750B
 9-5790B

- Tip**
 9-5746 150A .070 Air
 9-5747 100A .050 Air
 9-5748 50A .043 Air
 9-5751 150A .070 O₂
 9-5752 100A .052 O₂
 9-5753 50A .043 O₂
 9-5767 150A .016 N₂
 9-5766 100A .052 N₂
 9-5765 50A .043 N₂
 9-5755 150A .120 N₂ Gouging
 9-5756 85A .078 N₂ Gouging

- Electrode**
 9-5749 Air
 9-5754 N₂-ArH₂
 9-5760 O₂

Not Shown

- 8-0557 O-Ring (Sml. Shield Cup)
 8-5507 O-Ring (Lrg. Shield Cup)
 9-5743 Torch Body 70°
 9-5745 Torch Body 180°

THERMAL DYNAMICS®

THERMAL DYNAMICS® PCH/M-200

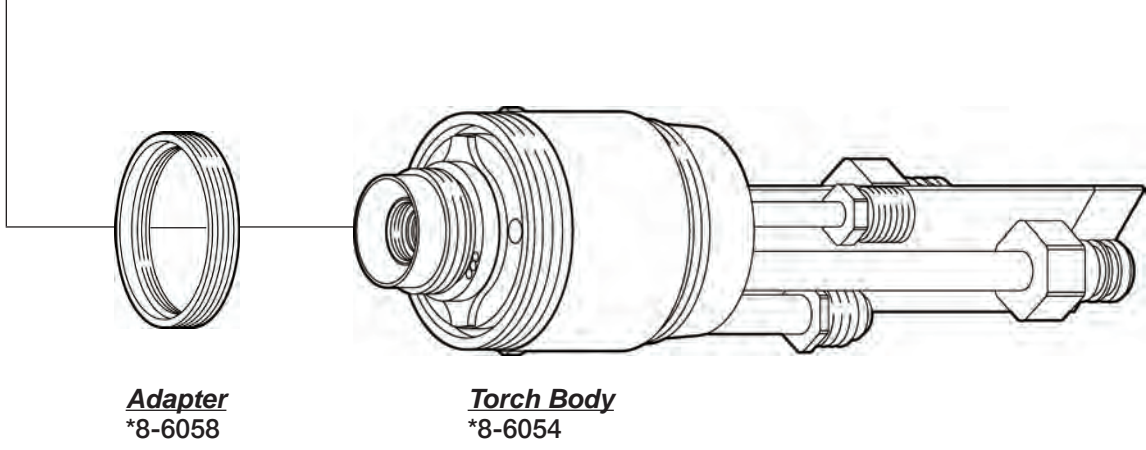
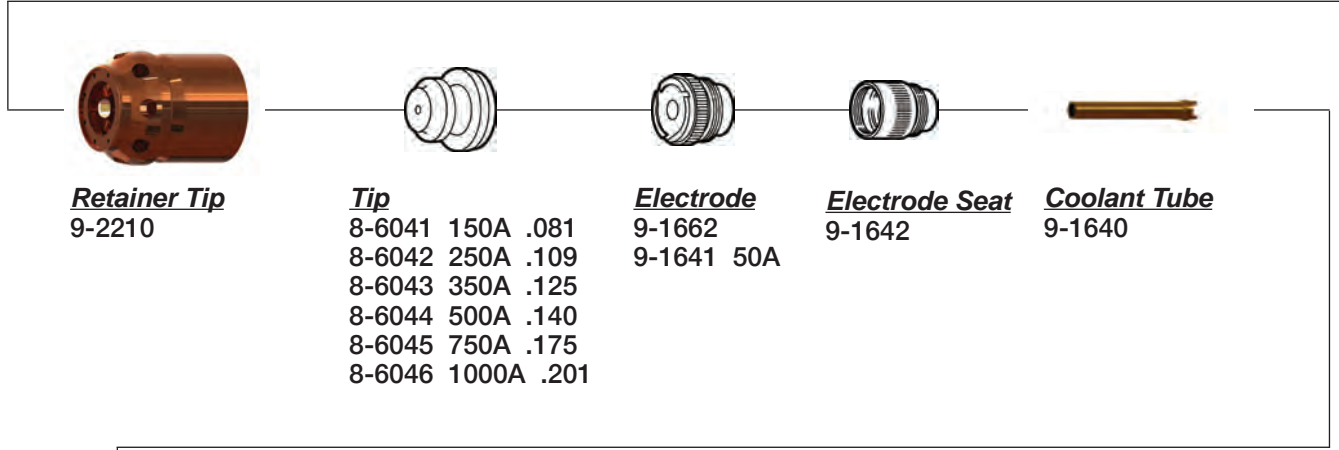
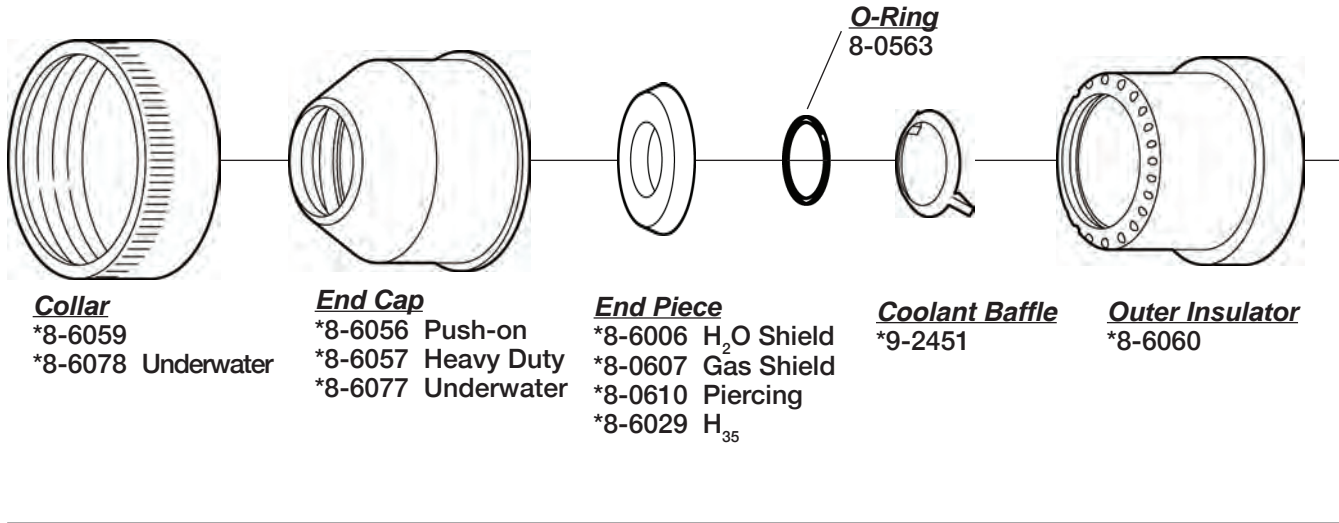

THERMAL DYNAMICS®

THERMAL DYNAMICS® PWM-300



End Cap
8-6515

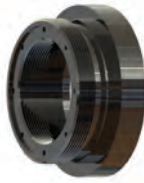

Outer Insulator
8-6581



Tip
8-6575 200A .093
8-6582 250A .113
8-6572 300A .125



O-Ring
9-2863



Tip Liner
8-6509



Electrode
9-1827



O-Ring
9-2956



Gasket
8-6512



O-Ring
8-0531

Not Shown

- 8-0534 O-Ring
- *8-6517 Tip/Liner Wrench

PLASMA



Shield Cup Shield
 20-1004 100-225A
 20-1005 300A
 20-1006 100-300A

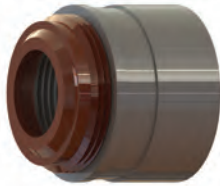

Shield Cup
 20-1002



Tip
 20-1031 100A
 20-1032 150A
 20-1033 225A
 20-1034 300A

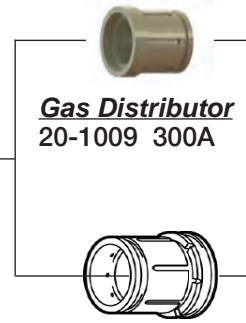

Gas Distributor
 20-1009 300A

Gas Distributor
 20-0008 50/225A



Electrode
 20-1016 150A
 20-1017 225A
 20-1018 300A
 20-1021

Not Shown

- *9-6410 Torch Body
- *20-0001 Consumable Wrench

THERMAL DYNAMICS[®] TD 750



Tip
 9-6055 35A
 9-6056 70A
 9-6057 105A
 9-6423 .037
 9-6424 70A